

CUSTOMER DRAWING

REVISIONS		DATE	APPROVED
SYM	ECN No.	DESCRIPTION	TAMMY
A		MASS PRODUCTION	09/20/2005

GND	P1	P2	GND
RX0+	1	32	TX3-
RX0-	2	31	TX3-
GND	3	30	TX3+
TX0+	4	29	GND
TX0-	5	28	RX3-
GND	6	27	RX3+
RX1+	7	26	GND
RX1-	8	25	TX2-
GND	9	24	TX2+
TX1+	10	23	GND
TX1-	11	22	RX2-
GND	12	21	RX2+
Side bands	13	20	GND
Side bands	14	19	Side bands
Side bands	15	18	Side bands
Side bands	16	17	Side bands
Side bands	17	16	Side bands
Side bands	18	15	Side bands
Side bands	19	14	Side bands
GND	20	13	GND
RX2+	21	12	TX1-
RX2-	22	11	TX1+
GND	23	10	GND
TX2+	24	9	RX1-
TX2-	25	8	RX1+
GND	26	7	GND
RX3+	27	6	TX0-
RX3-	28	5	TX0+
GND	29	4	GND
TX3+	30	3	RX0-
TX3-	31	2	RX0+
GND	32	1	GND

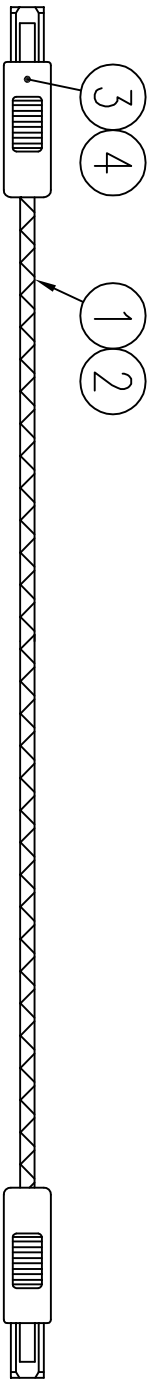
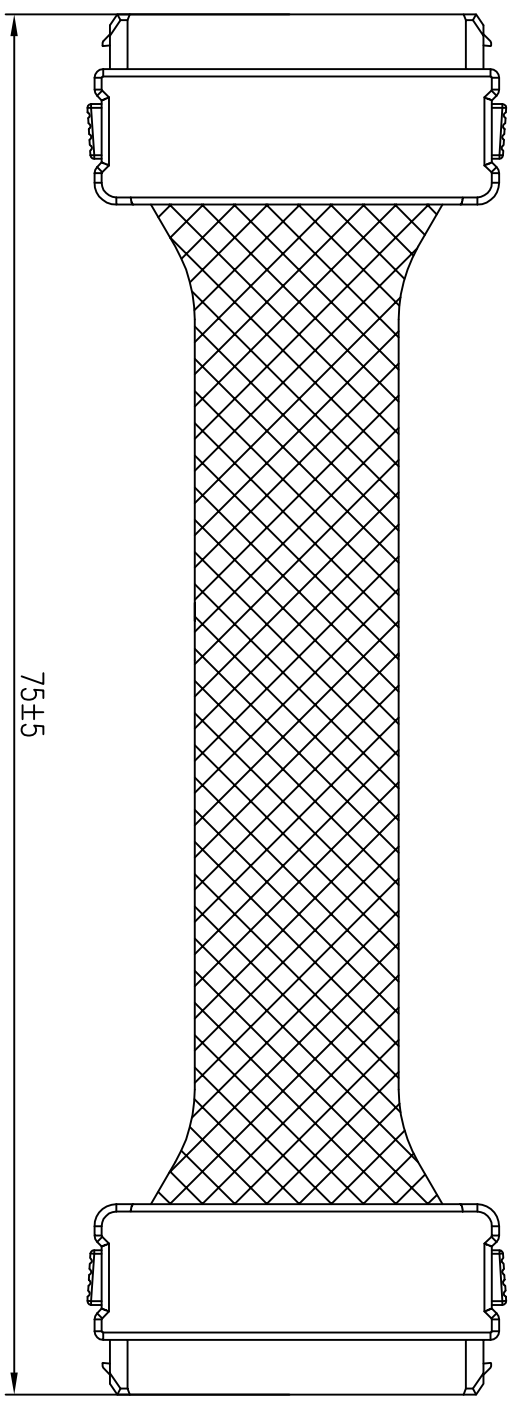
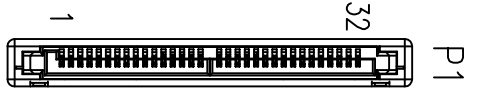

ITEM	PART NUMBER	DESCRIPTION
4	T70000010201A	PVC, 45P, Cd/Pb-FREE (EN-71), BLACK
3	T504933228110NO	SAS CONN., 4 PORTS, 32-POS., RECEPTACLE, STRAIGHT, W/LATCH, 15U
2		EXPANDO, BLACK
1	T60-11M-855	SERIAL ATA SKEWCLEAR CABLE, 26 AWG * 10-PRS + SHIELDED, UL 20744

APPROVALS	DATE	<h2 style="margin: 0;">TC&C Electronics Co.,Ltd</h2>		
DRAWN TAMMY	09/20/2005			
CHECKED		TITLE SATA 26AWG 1PR, SAS 32P TO SAS 32P, W/PLASTICBRAID, 26AWG, ASSO P/N=4642699936, L=75MM (不含頭)		
APPROVED		SCALE N.A.	PART NO.	DRAWING NO.
	UNIT MM	SHEET 1 OF 1	T107049320521	T107049320521
		CUSTOMER	A166	PART NO. 942160000209
				REV. AX1